



DIN 933 - ISO 4017 - UNI 5739 Hex Bolts

DIN 933 - ISO 4017 - UNI 5739 Sechskantschrauben

DIN 933 - ISO 4017 - UNI 5739 Boulons hexagonaux

DIN 933 - ISO 4017 - UNI 5739 Vite a testa esagonale

DIN 933 - ISO 4017 - UNI 5739 Tornillo hexagonal

Quality: 4.6 / 4.8 / 5.6 / 5.8 / 6.8 / 8.8 / 10.9 / 12.9

Coating Type: Zinc Plated / Hot Dip Galvanized / Geomet / Black Oxide

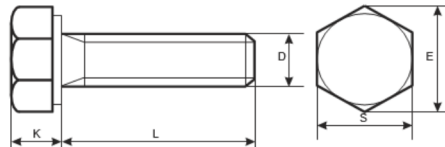

Size – D	Pitch (p)	E (Min.)	S (Min.)	S (Max.)	L	K (Min.)	K (Max.)
M8	1.25	14.38	12.57	13	FT	5.1	5.6
M10	1.5	17.77	15.57	16	FT	6.2	7
M12	1.75	20.03	17.57	18	FT	7.2	8
M16	2	26.17	23.16	24	FT	9.71	10.29
M18	2.5	29.56	26.16	27	FT	11.15	11.85
M20	2.5	32.95	29.16	30	FT	12.15	12.85
M22	2.5	37.29	33	34	FT	13.65	14.35
M24	3	39.55	35	36	FT	14.65	15.35
M27	3	45.2	40	41	FT	16.65	17.35
M30	3.5	50.85	45	46	FT	18.18	19.12
M33	3.5	55.37	49	50	FT	20.58	21.42
M36	4	60.79	53.8	55	FT	22.08	22.92
M39	4	66.44	58.8	60	FT	24.58	25.42
M42	4.5	71.3	63.1	65	FT	25.58	26.42
M45	4.5	76.95	68.1	70	FT	27.58	28.42
M48	5	82.6	73.1	75	FT	29.58	30.42
M52	5	88.25	78.1	80	FT	32.5	33.5
M56	5.5	93.56	82.8	85	FT	34.5	35.5
M60	5.5	99.21	87.8	90	FT	37.5	38.5
M64	6	104.86	92.8	95	FT	39.5	40.5



DIN 931 - ISO 4014 - UNI 5737 Hex Bolts

DIN 931 - ISO 4014 - UNI 5737 Sechskantschrauben

DIN 931 - ISO 4014 - UNI 5737 Boulons hexagonaux

DIN 931 - ISO 4014 - UNI 5737 Vite a testa esagonale

DIN 931 - ISO 4014 - UNI 5737 Tornillo hexagonal

Quality: 4.6 / 4.8 / 5.6 / 5.8 / 6.8 / 8.8 / 10.9 / 12.9

Coating Type: Zinc Plated / Hot Dip Galvanized / Geomet / Black Oxide

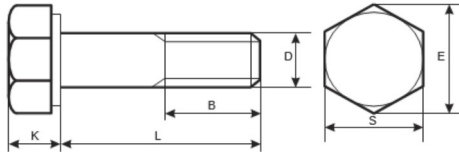

Size – D	Pitch (p)	E (Min.)	S (Min.)	S (Max.)	B			K (Min.)	K (Max.)
					L ≤ 125	L : 125-200	L ≥ 200		
M8	1.25	14.38	12.57	13	22	28	-	5.1	5.6
M10	1.5	17.77	15.57	16	26	32	45	6.2	7
M12	1.75	20.03	17.57	18	30	36	49	7.2	8
M16	2	26.17	23.16	24	38	44	57	9.71	10.29
M18	2.5	29.56	26.16	27	42	48	61	11.15	11.85
M20	2.5	32.95	29.16	30	46	52	65	12.15	12.85
M22	2.5	37.29	33	34	50	56	69	13.65	14.35
M24	3	39.55	35	36	54	60	73	14.65	15.35
M27	3	45.2	40	41	60	66	79	16.65	17.35
M30	3.5	50.85	45	46	66	72	85	18.18	19.12
M33	3.5	55.37	49	50	72	78	91	20.58	21.42
M36	4	60.79	53.8	55	78	84	97	22.08	22.92
M39	4	66.44	58.8	60	84	90	103	24.58	25.42
M42	4.5	71.3	63.1	65	90	96	109	25.58	26.42
M45	4.5	76.95	68.1	70	96	102	115	27.58	28.42
M48	5	82.6	73.1	75	102	108	121	29.58	30.42
M52	5	88.25	78.1	80	110	116	129	32.5	33.5
M56	5.5	93.56	82.8	85	118	124	137	34.5	35.5
M60	5.5	99.21	87.8	90	-	132	145	37.5	38.5
M64	6	104.86	92.8	95	-	140	153	39.5	40.5



DIN 6914 - EN 14399-4 - UNI 5712 HV Hex Bolts

DIN 6914 - EN 14399-4 - UNI 5712 Sechskantschrauben

DIN 6914 - EN 14399-4 - UNI 5712 Boulons hexagonaux

DIN 6914 - EN 14399-4 - UNI 5712 Vite a testa esagonale

DIN 6914 - EN 14399-4 - UNI 5712 Tornillo hexagonal

Quality: 10.9 / 12.9

Coating Type: Zinc Plated / Hot Dip Galvanized / Geomet / Black Oxide

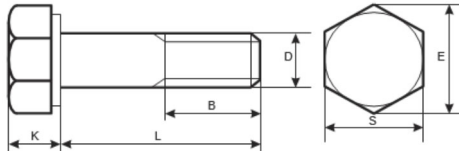

Size – D	Pitch (p)	E (Min.)	S (Min.)	S (Max.)	B (Min.)	B Max.)	K (Min.)	K (Max.)
M16	2	29.56	26.16	27	28	30	9.25	10.75
M20	2.5	35.03	31	32	33	35.5	12.1	13.9
M22	2.5	39.55	35	36	34	36.5	13.1	14.9
M24	3	45.2	40	41	39	43	14.1	15.9
M27	3	50.85	45	46	41	45	16.1	17.9
M30	3.5	55.37	49	50	44	49.5	17.95	20.05
M36	4	66.44	58.8	60	52	59	21.95	24.05
M39	4	71.3	63.1	65	68	75	23.95	26.05
M42	4.5	76.95	68.1	70	74	82.5	24.95	27.05
M45	4.5	82.6	73.1	75	76	84.5	26.95	29.05
M48	5	88.25	78.1	80	82	92	28.95	31.05
M56	5.5	99.2	87.8	90	90	101.5	33.75	36.25
M64	6	110.5	97.8	100	100	113	38.75	41.25



DIN 7990 Hex Bolts

DIN 7990 Sechskantschrauben

DIN 7990 Boulons hexagonaux

DIN 7990 Vite a testa esagonale

DIN 7990 Tornillo hexagonal

Quality: 4.6 / 5.6 / 6.8 / 8.8

Coating Type: Zinc Plated / Hot Dip Galvanized / Geomet / Black Oxide

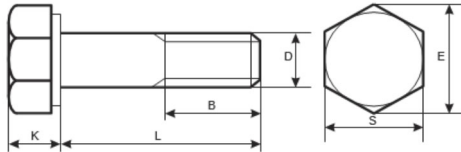

Size – D	Pitch (p)	E (Min.)	S (Min.)	S (Max.)	B	K (Min.)	K (Max.)
M12	1.75	20.88	18.48	19	17.75	7.55	8.45
M16	2	26.17	23.16	24	21	9.25	10.75
M20	2.5	32.95	29.16	30	23.5	12.1	13.9
M22	2.5	35.03	31	32	25.5	13.1	14.9
M24	3	39.55	35	36	26	14.1	18.9
M27	3	45.2	40	41	29	16.1	17.9
M30	3.5	50.85	45	46	30.5	17.95	20.05



EN 15048 SB Hex Bolts

EN 15048 SB Sechskantschrauben

EN 15048 SB Boulons hexagonaux

EN 15048 SB Vite a testa esagonale

EN 15048 SB Tornillo hexagonal

Quality: 8.8 / 10.9 - **SB MARKING**

Coating Type: Zinc Plated / Hot Dip Galvanized / Geomet / Black Oxide

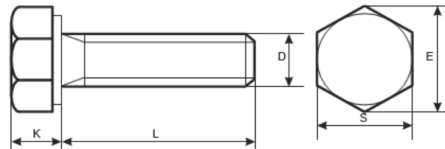

Size – D	Pitch (p)	E (Min.)	S (Min.)	S (Max.)	L	K (Min.)	K (Max.)
M12	1.75	20.03	17.57	18	FT	7.2	8
M16	2	26.17	23.16	24	FT	9.71	10.29
M20	2.5	32.95	29.16	30	FT	12.15	12.85
M24	3	39.55	35	36	FT	14.65	15.35
M30	3.5	50.85	45	46	FT	18.18	19.12
M36	4	60.79	53.8	55	FT	22.08	22.92



ASME B18.2.1 - ASTM A193 Hex Bolts

ASME B18.2.1 - ASTM A193 Sechskantschrauben

ASME B18.2.1 - ASTM A193 Boulons hexagonaux

ASME B18.2.1 - ASTM A193 Vite a testa esagonale

ASME B18.2.1 - ASTM A193 Tornillo hexagonal

Quality: B7, B7M, B16

Coating Type: Zinc Plated / Hot Dip Galvanized / Geomet / Black Oxide

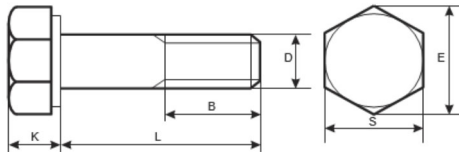

Size – INCH	Pitch-UNC	E (Min.)	E (Max.)	S (Min.)	S (Max.)	B <6"(s)	B >6"(L)	K (Min.)	K (Max.)
1/2	13	0.84	0.866	0.736	0.750	1.250	1.500	0.302	0.323
9/16	12	0.91	0.938	0.798	0.812	1.375	1.625	0.348	0.371
5/8	11	1.051	1.083	0.922	0.938	1.500	1.750	0.378	0.403
3/4	10	1.254	1.299	1.100	1.125	1.750	2.000	0.455	0.483
7/8	9	1.465	1.516	1.285	1.312	2.000	2.250	0.531	0.563
1	8	1.675	1.732	1.469	1.500	2.250	2.500	0.591	0.627
1-1/8	8	1.859	1.949	1.631	1.688	2.500	2.750	0.658	0.718
1-1/4	8	2.066	2.165	1.812	1.875	2.750	3.000	0.749	0.813
1-3/8	8	2.273	2.382	1.994	2.062	3.000	3.250	0.810	0.878
1-1/2	8	2.48	2.598	2.175	2.250	3.250	3.500	0.902	0.974
1-5/8	8	2.686	2.815	2.356	2.438	3.500	3.750	0.962	1.038
1-3/4	8	2.893	3.031	2.538	2.625	3.750	4.000	1.054	1.134
1-7/8	8	3.099	3.248	2.719	2.812	4.000	4.250	1.114	1.198
2	8	3.306	3.464	2.900	3.000	4.250	4.500	1.175	1.263
2-1/4	8	3.719	3.897	3.262	3.375	-	5.000	1.327	1.423
2-1/2	8	4.133	4.33	3.625	3.750	-	5.500	1.479	1.583
2-3/4	8	4.546	4.763	3.988	4.125	-	6.000	1.632	1.744
3	8	4.959	5.196	4.350	4.500	-	6.500	1.815	1.935

**ASME B18.2.6M Hex Bolts**

ASME B18.2.6M Sechskantschrauben

ASME B18.2.6M Boulons hexagonaux

ASME B18.2.6M Vite a testa esagonale

ASME B18.2.6M Tornillo hexagonal

Quality: ASTM A325M or ASTM A490M

Coating Type: Zinc Plated / Hot Dip Galvanized / Geomet / Black Oxide

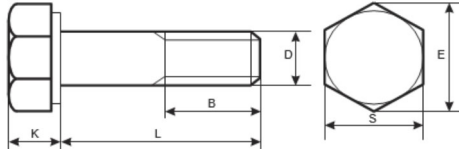

Size – D	Pitch-UNC	E (Min.)	E (Max.)	S (Min.)	S (Max.)	B (Ref.)	K (Min.)	K (Max.)
M12	1.75	22.78	24.25	20.16	21	25	7.05	7.95
M16	2	29.56	31.18	26.16	27	31	9.25	10.75
M20	2.5	37.29	39.26	33	34	36	11.6	13.4
M22	2.5	29.55	41.57	35	36	38	13.1	14.9
M24	3	45.20	47.34	50	41	41	14.1	15.9
M27	3	50.85	53.12	45	46	44	16.1	17.9
M30	3.5	55.27	57.74	49	50	49	17.65	19.75
M36	4	66.44	69.28	58.8	60	56	21.45	23.55



ASME B18.2.1 - ASTM A307 Hex Bolts
 ASME B18.2.1 - ASTM A307 Sechskantschrauben
 ASME B18.2.1 - ASTM A307 Boulons hexagonaux
 ASME B18.2.1 - ASTM A307 Vite a testa esagonale
 ASME B18.2.1 - ASTM A307 Tornillo hexagonal

Quality: 307A, 307B, 307C

Coating Type: Zinc Plated / Hot Dip Galvanized / Geomet / Black Oxide

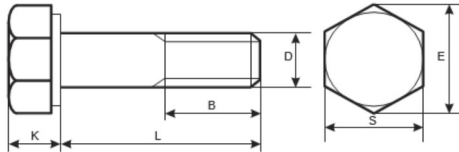

Size – INCH	Pitch-UNC	E (Min.)	E (Max.)	S (Min.)	S (Max.)	B <6"(s)	B >6"(L)	K (Min.)	K (Max.)
1/2	13	0.84	0.866	0.736	0.750	1.250	1.500	0.302	0.323
9/16	12	0.91	0.938	0.798	0.812	1.375	1.625	0.348	0.371
5/8	11	1.051	1.083	0.922	0.938	1.500	1.750	0.378	0.403
3/4	10	1.254	1.299	1.100	1.125	1.750	2.000	0.455	0.483
7/8	9	1.465	1.516	1.285	1.312	2.000	2.250	0.531	0.563
1	8	1.675	1.732	1.469	1.500	2.250	2.500	0.591	0.627
1-1/8	8	1.859	1.949	1.631	1.688	2.500	2.750	0.658	0.718
1-1/4	8	2.066	2.165	1.812	1.875	2.750	3.000	0.749	0.813
1-3/8	8	2.273	2.382	1.994	2.062	3.000	3.250	0.810	0.878
1-1/2	8	2.48	2.598	2.175	2.250	3.250	3.500	0.902	0.974
1-5/8	8	2.686	2.815	2.356	2.438	3.500	3.750	0.962	1.038
1-3/4	8	2.893	3.031	2.538	2.625	3.750	4.000	1.054	1.134
1-7/8	8	3.099	3.248	2.719	2.812	4.000	4.250	1.114	1.198
2	8	3.306	3.464	2.900	3.000	4.250	4.500	1.175	1.263
2-1/4	8	3.719	3.897	3.262	3.375	-	5.000	1.327	1.423
2-1/2	8	4.133	4.33	3.625	3.750	-	5.500	1.479	1.583
2-3/4	8	4.546	4.763	3.988	4.125	-	6.000	1.632	1.744
3	8	4.959	5.196	4.350	4.500	-	6.500	1.815	1.935



DIN 960 - UNI 5738 Hex Bolts

DIN 960 - UNI 5738 Sechskantschrauben

DIN 960 - UNI 5738 Boulons hexagonaux

DIN 960 - UNI 5738 Vite a testa esagonale

DIN 960 - UNI 5738 Tornillo hexagonal

Quality: 4.6 / 4.8 / 5.6 / 5.8 / 6.8 / 8.8 / 10.9 / 12.9

Coating Type: Zinc Plated / Hot Dip Galvanized / Geomet / Black Oxide

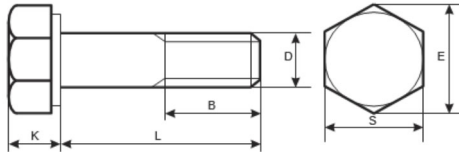

Size – D	Pitch (p)	E (Min.)	S (Min.)	S (Max.)	B			K (Min.)	K (Max.)
					L ≤ 125	L : 125-200	L ≥ 200		
M8	1	14.38	12.57	13	22	28	-	5.1	5.6
M10	1- 1.25	18.72	16.57	17	26	32	45	6.2	7
M12	1.25 – 1.5	20.88	18.48	19	30	36	49	7.2	8
M14	1.5	23.91	21.16	22	34	40	53	9	8
M16	1.5	26.17	23.16	24	38	44	57	9.71	10.29
M18	1.5 – 2	29.56	26.16	27	42	48	61	11.15	11.85
M20	1.5 – 2	32.95	29.16	30	46	52	65	12.15	12.85
M22	1.5 – 2	37.29	33	34	50	56	69	13.65	14.35
M24	1.5 – 2	39.55	35	36	54	60	73	14.65	15.35
M27	2	45.2	40	41	60	66	79	16.65	17.35
M30	2	50.85	45	46	66	72	85	18.18	19.12
M33	2	55.37	49	50	72	78	91	20.58	21.42
M36	3	60.79	53.8	55	78	84	97	22.08	22.92
M39	3	66.44	58.8	60	84	90	103	24.58	25.42
M42	3	71.3	63.1	65	90	96	109	25.58	26.42
M45	3	76.95	68.1	70	96	102	115	27.58	28.42
M48	3	82.6	73.1	75	102	108	121	29.58	30.42
M52	3	88.25	78.1	80	110	116	129	32.5	33.5



DIN 961 - UNI 5738 Hex Bolts

DIN 961 - UNI 5738 Sechskantschrauben

DIN 961 - UNI 5738 Boulons hexagonaux

DIN 961 - UNI 5738 Vite a testa esagonale

DIN 961 - UNI 5738 Tornillo hexagonal

Quality: 4.6 / 4.8 / 5.6 / 5.8 / 6.8 / 8.8 / 10.9 / 12.9

Coating Type: Zinc Plated / Hot Dip Galvanized / Geomet / Black Oxide

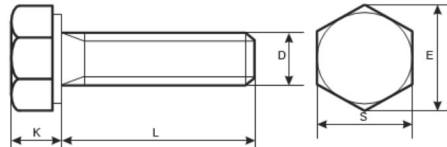

Size – D	Pitch (p)	E (Min.)	S (Min.)	S (Max.)	L	K (Min.)	K (Max.)
M8	1	14.38	12.57	13	FT	5.1	5.6
M10	1- 1.25	18.72	16.57	17	FT	6.2	7
M12	1.25 – 1.5	20.88	18.48	19	FT	7.2	8
M14	1.5	23.91	21.16	22	FT	9	8
M16	1.5	26.17	23.16	24	FT	9.71	10.29
M18	1.5 – 2	29.56	26.16	27	FT	11.15	11.85
M20	1.5 – 2	32.95	29.16	30	FT	12.15	12.85
M22	1.5 – 2	37.29	33	34	FT	13.65	14.35
M24	1.5 – 2	39.55	35	36	FT	14.65	15.35
M27	2	45.2	40	41	FT	16.65	17.35
M30	2	50.85	45	46	FT	18.18	19.12
M33	2	55.37	49	50	FT	20.58	21.42
M36	3	60.79	53.8	55	FT	22.08	22.92
M39	3	66.44	58.8	60	FT	24.58	25.42
M42	3	71.3	63.1	65	FT	25.58	26.42
M45	3	76.95	68.1	70	FT	27.58	28.42
M48	3	82.6	73.1	75	FT	29.58	30.42
M52	3	88.25	78.1	80	FT	32.5	33.5



DIN 186 - T-Head bolts

DIN 186 - Hammerkopfschrauben

DIN 186 - Boulons à tête en T

DIN 186 - Bulloni con testa a martello

DIN 186- Tornillos con cabeza en T

Quality: 4.6 / 4.8 / 5.6 / 5.8 / 6.8 / 8.8 / 10.9 / 12.9

Coating Type: Zinc Plated / Hot Dip Galvanized / Geomet / Black Oxide

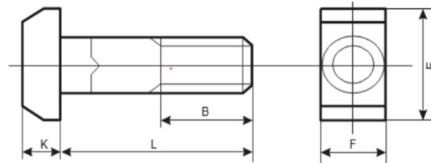

Size – D	Pitch (p)	E	F	K	B	
					L ≤ 140	L ≥ 140
M16	2	30	16	10.5	38	44
M20	2.5	36	20	13	46	52
M24	3	43	24	15	54	60
M30	3.5	54	30	19	66	72
M36	4	66	36	23	78	84
M42	4.5	80	42	26	90	96
M48	5	88	48	30	102	108



DIN 912 - Hexagon socket Head Cap Screws

DIN 912 - Zylinderschraube mit Innensechskant

DIN 912 - Vis à tête cylindrique à six pans creux

DIN 912 - Viti a testa cilindrica con cava esagonale

DIN 912 - Tornillos con cabeza hueca hexagonal

Quality: 8.8 / 10.9 / 12.9

Coating Type: Zinc Plated / Hot Dip Galvanized / Geomet / Black Oxide

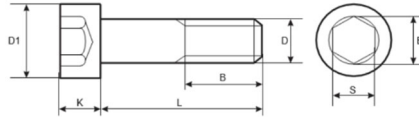

Size – D	Pitch (p)	E (Min.)	S	K	B
M16	2	16	14	16	44
M20	2.5	19.5	17	20	52
M24	3	21.73	19	24	60
M30	3.5	25.15	22	30	72
M36	4	30.85	27	36	84
M42	4.5	36.57	32	42	96
M48	5	41.13	36	48	108
M56	5.5	46.83	41	56	124
M64	6	52.53	46	64	140



DIN 561 - Hex Bolts

DIN 561 - Sechskantschrauben

DIN 561 - Boulons hexagonaux

DIN 561 - Vite a testa esagonale

DIN 561 - Tornillo hexagonal

Quality: 8.8 / 10.9 / 12.9

Coating Type: Zinc Plated / Hot Dip Galvanized / Geomet / Black Oxide

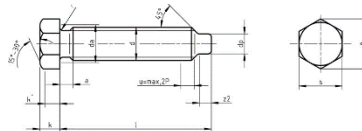

Size – D	Pitch (p)	E (Min.)	S	K	Z2	DP
M16	2	19.92	18	11	8.36	12
M20	2.5	26.75	24	14	10.36	15
M24	3	33.53	30	17	12.43	18
M30	3.5	38.98	36	21	15.43	23
M36	4	51.28	46	25	18.43	28
M42	4.5	61.31	55	30	21.52	32
M48	5	72.61	65	34	24.52	38
M56	5.5	83.91	75	40	28.52	45



DIN 609 - Hex Bolts

DIN 609 - Sechskantschrauben

DIN 609 - Boulons hexagonaux

DIN 609 - Vite a testa esagonale

DIN 609 - Tornillo hexagonal

Quality: 8.8 / 10.9 / 12.9

Coating Type: Zinc Plated / Hot Dip Galvanized / Geomet / Black Oxide

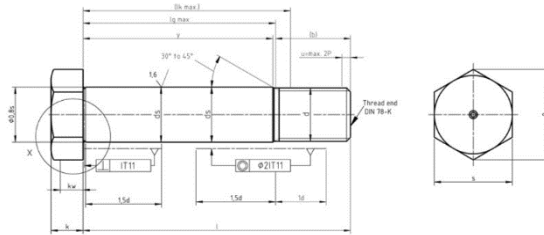

Size – D	Pitch (p)	E (Min.)	S	K	B L ≤ 50	B 50 ≤ L ≤ 150	B L ≥ 150
M16	1.5	26.17	24	10	25	27	32
M20	2	32.95	30	12.5	28.5	30.5	35.5
M24	2	39.55	36	15	-	36.5	41.5
M30	2	50.85	46	19	-	43	48
M36	3	60.79	55	22	-	49	54
M42	3	71.3	65	26	-	56	61
M48	3	82.6	75	30	-	63	68